

S9000 MIX-H

MIXING UNIT (H)

3-way rotary brass valves with electric actuator S9000 MIX and clip system

FIRST®



3-POINT CONTROL  STOP AT INTERMEDIATE POSITIONS



FMV H-151C

Valves are available in DN 25, with by-pass and pump connection and are rated PN10.

- FIRŠT FMV H-151C valves have the running nut for pump connection, the male connection to the manifold and the adjustable bypass on the way back and adjustable parallel dimension (125-90mm), with T pieces.
- Valves are intended to be installed in heating and/or cooling systems, sanitary applications and distribution groups. Valves have equal percentage flow characteristic.

OPERATION

S9000-MIX is an electric motor actuator designed for operating rotary mixing valves. Actuators are controlled by 3-point signal and can be manually operated.

Valves are suitable for long-lasting operation because of special sealing construction. Small rotation torque reduces possibility of valve blocking. FIRŠT S9000 MIX-H electric actuators allow high regulating accuracy and easy installation with one-click CLIP system.

Valves are used for mixing applications.

MAINTENANCE

Valve requires no maintenance. The installation of suitable strainer is recommended.

INSTALLATION POSITIONS

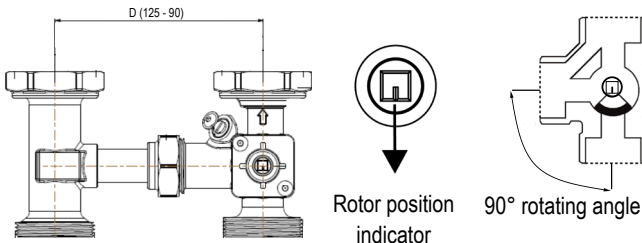

CLIP SYSTEM

Compact design of the valve allows easy assembling and disassembling. CLIP system allows easy installation of the actuator on the valve body with single click without any tools.



ELECTRICAL CONNECTION

3-point control SPDT

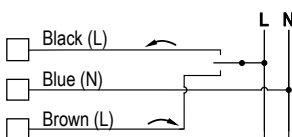

Optional: potential free output S1

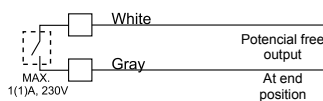

TECHNICAL DATA

Pressure class:	PN 10
Medium:	water, glycol < 50% water quality as per VDI 2035
Media temperature:	min. +2°C max. +110°C
Leakage ($\Delta p=1$ bar):	max. 0,1% Kvs
Max. diff. pressure:	1 bar
Connections:	Rp internal thread (EN 10226-1) G external thread (ISO 228-1)

Material

Valve body:	Brass, CW617N
Shaft and rotor:	Brass, CW617N
Bushing:	PTFE
O-Rings:	EPDM,FKM

EQUAL PERCENTAGE FLOW CHARACTERISTIC

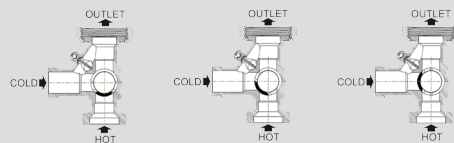
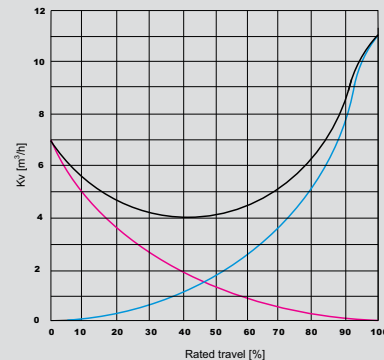

TECHNICAL DATA: ACTUATOR

Control:	3-point SPDT
Supply voltage:	230 VAC 50Hz
Rotation time:	110s/90°
Power consumption:	5 VA
Max. Torque:	5 Nm
Protection class:	II
Enclosure rating:	IP44
Connection cable:	1 m, 3 x 0,75 mm²
Direction of rotation:	defined CW/ CCW
Manual operation:	with handle and button on the cover
Position indicator:	handle with reversible scale
Ambient temperature:	0°C...+55°C
Storage temperature:	-10°C...+70°C
Humidity:	RH 0%..80% (non condensed)

FIRST®

FIRŠT d.o.o.
Koroška cesta 56
SI-3320 Velenje
SLOVENIA

phone: +386 3 898 35 00
fax: +386 3 898 35 35
email: info@first.si
web: www.first.si

www.first.si
Let First be your first choice.



S9000 MIX-H

MIXING UNIT (H)

3-way rotary brass valves with electric actuator S9000 MIX and clip system

FMV H-151C

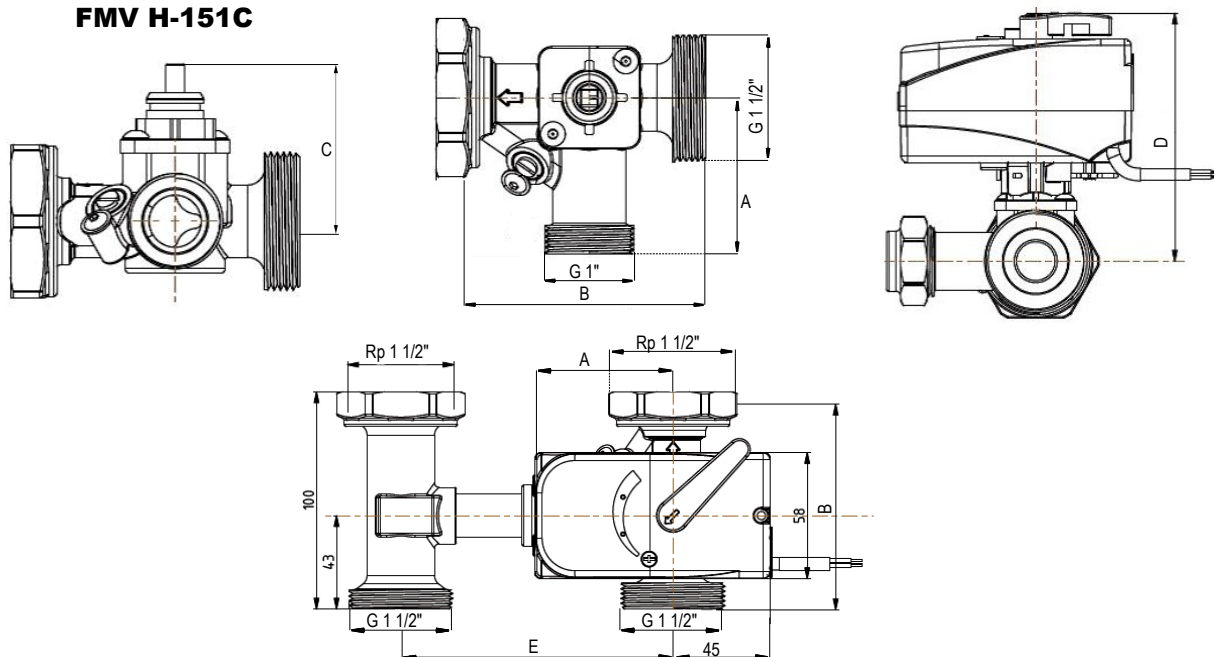

S9000 MIX-H 151C

Code	Type	DN	Kvs	Voltage	Rotation time	Connection	A	B	C	D	Weight [kg]	Price (€)
11078	S9000 MIX-H 151C	25	10	230V~50Hz	110s/90°	G1 1/2, G1 M, Rp 1 1/2	58	90	55	116	1,1	
11079	S9000 MIX-H 151C	25	6	230V~50Hz	110s/90°	G1 1/2, G1 M, Rp 1 1/2	58	90	55	116	1,1	

S9000 MIX-H 151C, complete set with T piece

Code	Type	DN	Kvs	Voltage	Rotation time	Connection	A	B	C	D	E	Weight [kg]	Price (€)
11094	S9000 MIX-H 151C	25	10	230V~50Hz	110s/90°	G1 1/2, G1 M, Rp 1 1/2	58	90	55	116	125-90	1,6	
11095	S9000 MIX-H 151C	25	6	230V~50Hz	110s/90°	G1 1/2, G1 M, Rp 1 1/2	58	90	55	116	125-90	1,6	

Working way

Valves allow mixing between two fluids, warm and cold water, to get the desired temperature. The valve is right mounting with adjustable bypass. The bypass can be adjusted up to 50% of the total valve flow.

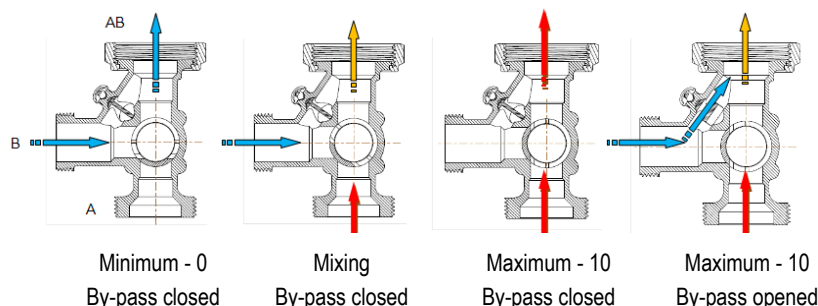

Installation examples

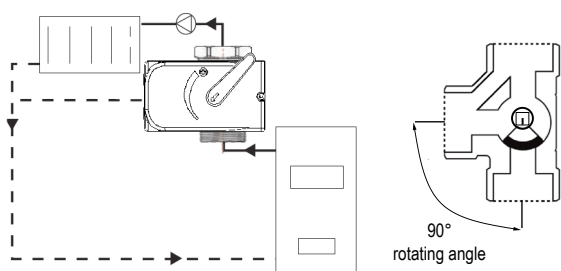

Features and options

- **Auxiliary switch:** one potential free auxiliary switch in the end position of the actuator is available as an option.
- **Molex connector:** optional Molex connector (IP40) and optional specially sealed Molex cable (IP44).
- **Different running times:** 20s/90°, 40s/90°, 80s/90°, 110s/90° or 220s/90°.
- **Power supply:** 230 VAC 50Hz, 24 VAC 50 Hz.
- **Manual control handle:** with or without manual control handle.
- **Solar/cooling adapter:** Heat barrier for protection of the actuator in solar or cooling systems.

CE In accordance with PED, LVD, RoHS2, EMC.